

ROHRFLEX

ADVANCED GERMAN ENGINEERING 

ROHRFLEX ADVANCED PIPING SYSTEM | CATALOGUE



HOT AND COLD PPRC PIPING

ROHRFLEX PIPING SYSTEM ADVANTAGES

The Rohrflex Piping System was introduced back in 2004 as an alternative towards galvanized iron pipes that are prone to rust and leaks. With Rohrflex, we make sure that your house truly becomes your home by making sure your waterline system is both leak-proof and rust-proof. We make sure that all the water that comes out your pipe is safe and hygienic so that you can enjoy top-quality fresh water.

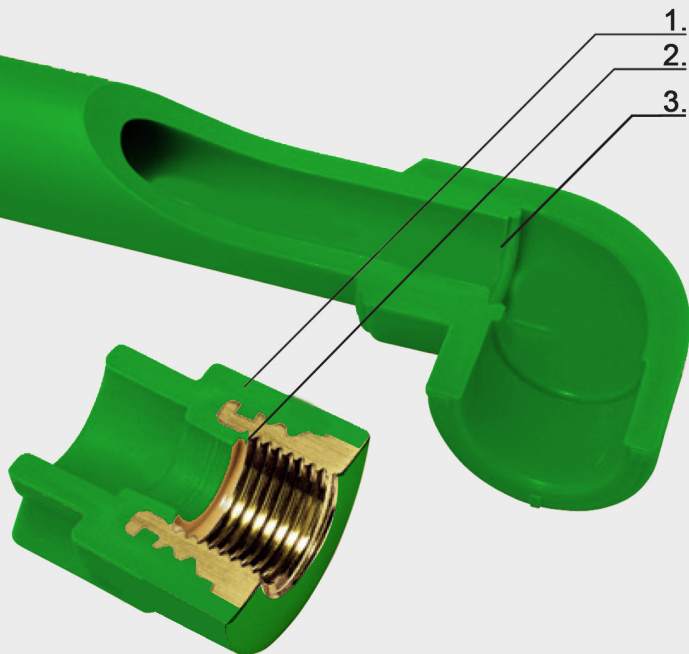

1. Rohrflex Dovetail Groove Structured Fittings

Rohrflex PPRC Fittings uses Rohrflex Dovetail Grooved Structured Technology that is more advanced than the typical general structure of PPRC fittings. With the Rohrflex Dovetail Grooved Structured Technology, your piping system has a higher leak-proof performance thus ensuring a superior waterline system.

2. Brass Fittings

Rohrflex uses high-grade brass fittings that are zinc-resistant. This makes Rohrflex fittings almost indestructible compared to the normal PPRC fittings that uses common materials such as stainless steel among others.

3. European Raw Material

Rohrflex uses LyondellBasell Industries high-grade virgin raw materials to ensure the heightened quality of the pipes. Because of this, Rohrflex PPRC Pipes can have a temperature tolerance of up to 100 degrees Celsius. Together with the German Technology imbued in its engineering, Rohrflex Advanced Piping System assures you a high-performance waterline system in your home, office, or wherever you may need it to be.



**Rohrflex Dovetail
Groove Structured
Fittings**



**Ordinary
Structured
Fittings**



ROHRFLEX

ADVANCED GERMAN ENGINEERING 

ROHRFLEX PIPING SYSTEM HIGHLIGHTS

Rohrflex Advanced PPRC Piping System are made with the best machines from Germany together with the best raw materials all over Europe to create a product that will last a lifetime. Because of this, the Rohrflex Piping System surpasses European standards according to DIN 8077/78 and the DVGW which is a renowned authority when it comes to the waterline industry.



GERMAN ENGINEERING

Rohrflex Piping System is made through German-made Battenfeld machines. These machines surpass stringent quality standards to make sure all pipes made are not undersized and can withstand high temperature and pressure tolerance. The operation systems in these machines are also regularly updated to ensure product-engineering accuracy.

COMPLETE RANGE

Rohrflex Piping System has a complete range of pipes and fittings to ensure flexibility of connection in your waterline system. The Rohrflex Piping System also has the sizes you need for any requirement you may need from the smaller sizes needed for your homes to the larger sizes needed for your plants and factories.

INTERNATIONALLY CERTIFIED



Bodycote

ROHRFLEX APPLICATION/S



CONDOS



HOUSES



WAREHOUSES



SCHOOLS



PLANTS



GAS STATIONS



HOSPITALS



CHEMICALS

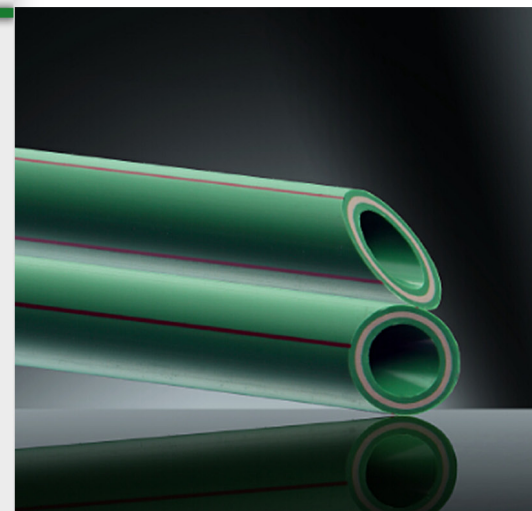

ROHRFLEX

ADVANCED GERMAN ENGINEERING 

ROHRFLEX ADVANCED PIPING SYSTEM | CATALOGUE

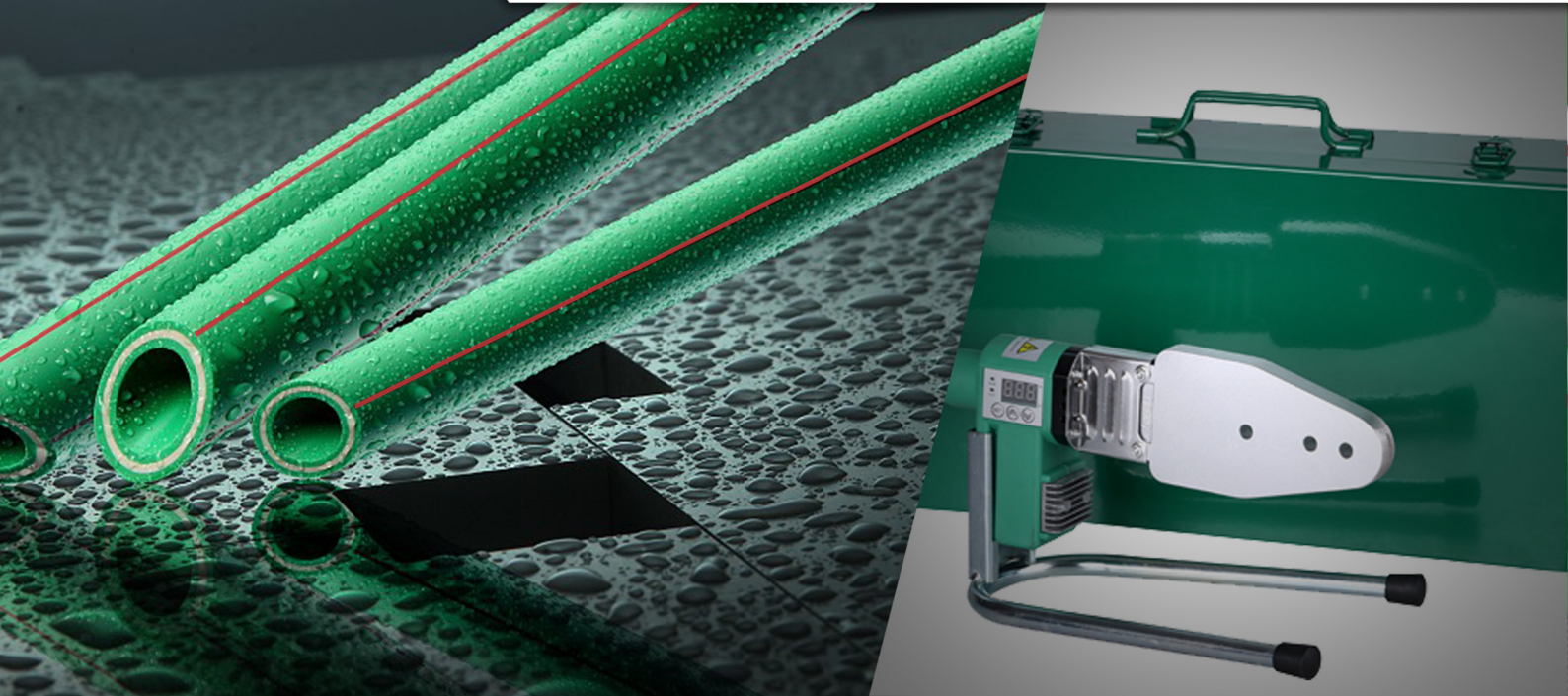

ROHRFLEX PPRC PIPING SYSTEM

- 100% premium European virgin raw-materials
- Grooved fittings technology
- Up to 100°C temperature tolerance
- High chemical resistance
- Absolutely leak-proof
- Noise free at high flow rates
- Recommended for high-rise projects



EXCLUSIVELY DISTRIBUTED BY:



www.techglobal.com.ph
sales@techglobal.com.ph

Bodycote

Fax No.: (02) 533.84.31
Landline Nos.: (02) 997.0972 | (02) 998.8757 | (02) 782.2262
Mobile Nos.: 0917.813.8480 | 0932.885.8895 | 0998.542.1965